

REVISION HISTORY				
ZONE	REV	DESCRIPTION	DATE	APPROVED
	-		9/17/2018	

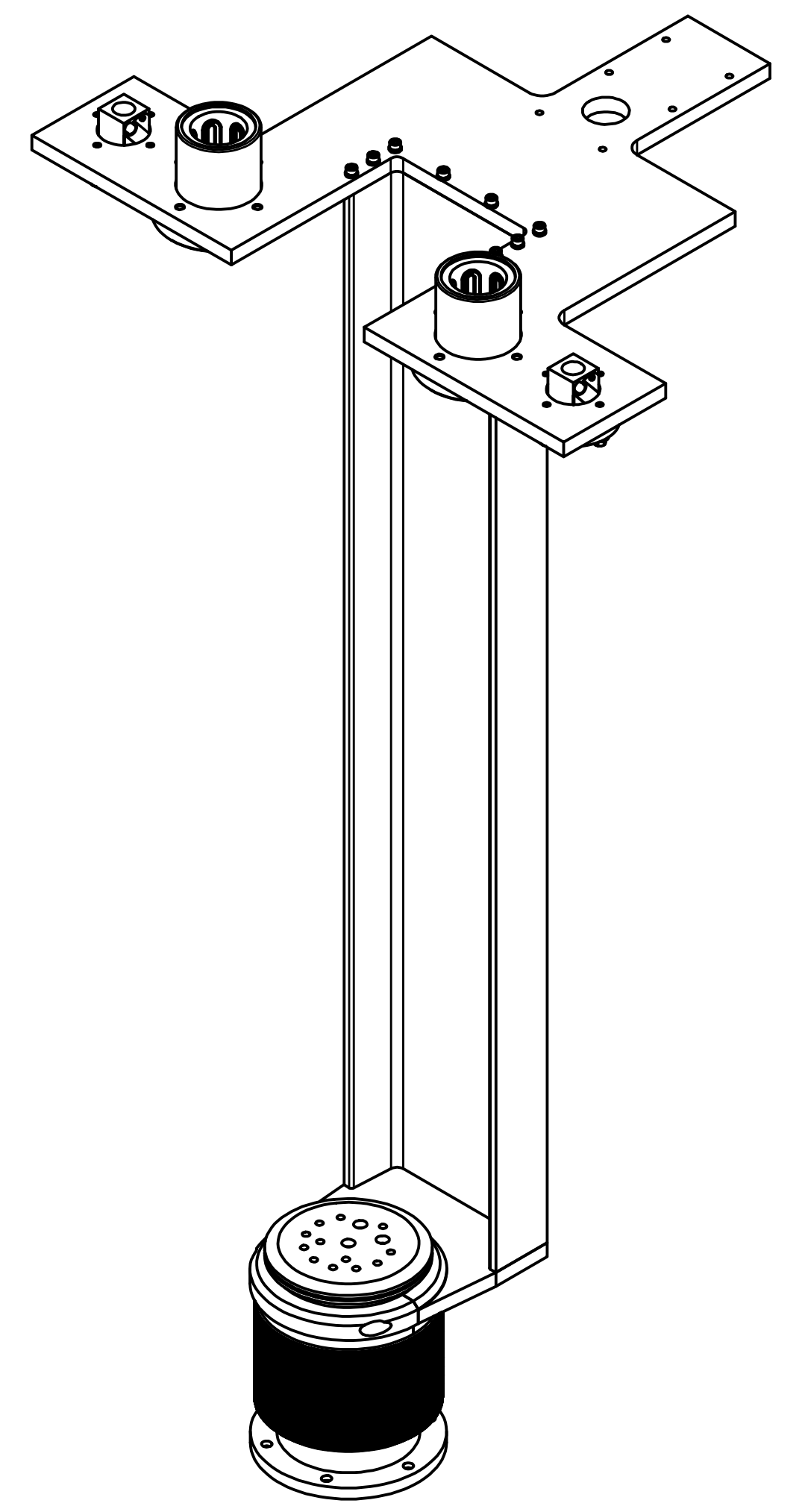
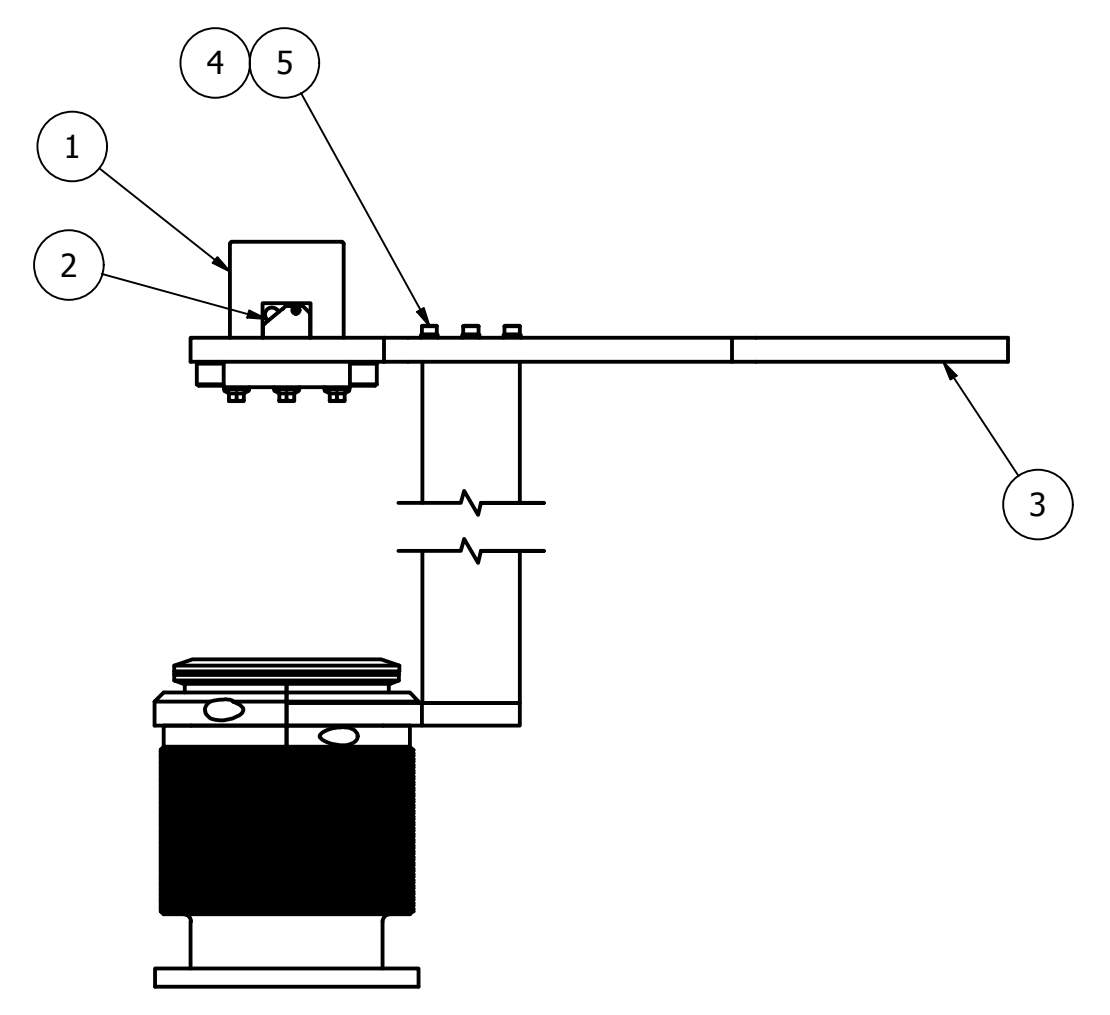
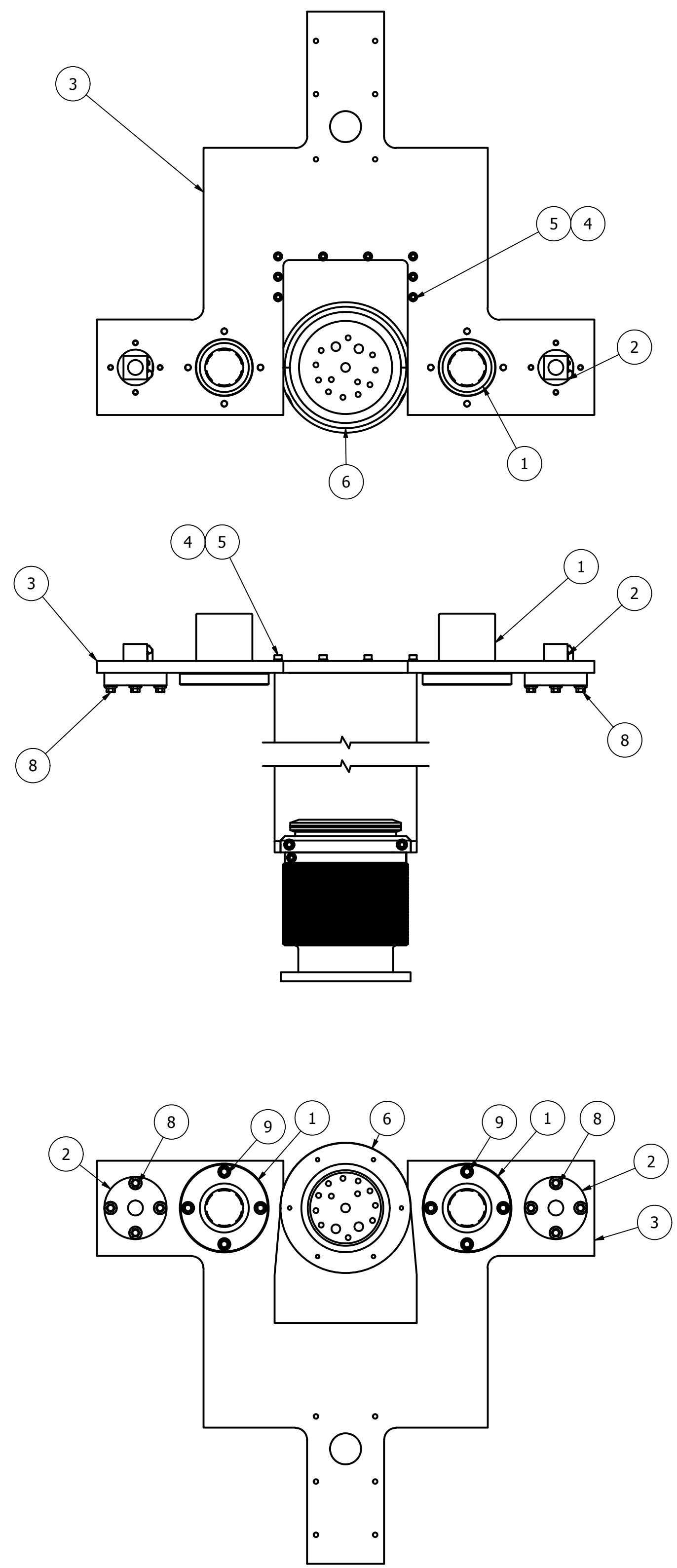

PARTS LIST			
ITEM	QTY	PART NUMBER	DESCRIPTION
1	2	6483K580	FLANGE-MOUNTED LINEAR BALL BRNG
2	2	F10095062	ACTUATOR_ DUFF NORTON UM28632 PLATE
3	1	MDT-017990-0800-01	E1039 PPT Lifter Mid Plate Detail
4	8	90945A741	MIL SPEC. 300 SERIES SS FLAT WASHER
5	8	92196A249	18-8 STAINLESS STEEL SOCKET HEAD CAP SCREW
6	1	SAS-017990-0100	E1039 PPT Bellows and Lifting Bar Assembly
7	8	98019A232	MIL SPEC. 300 SERIES SS FLAT WASHER
8	8	94288A116	EXTREME-STRENGTH SS FLANGE HEAD CAP SCREW
9	8	92200A624	MILITARY SPECIFICATION SOCKET HEAD CAP SCREW

DRAWN S. Cannon	9/17/2018	NMSU Physical Science Laboratory	
CHECKED		TITLE	
QA		E1039 PPT Lifting Plate Assembly	
MFG			
APPROVED			
		SIZE D	DWG NO SAS-017990-0800
		SCALE 1 / 4	REV -
		SHEET 1 OF 1	